



## Profile Crossbar Installation Instructions



### Package Contents:

- (2) Crossbars
- (4) Crossbar End Caps
- (4) ¼-20 x ½" Narrow Shoulder Screws
- (4) ¼-20 x 1-1/4" Button Head Screws
- (1) Hex Key

1.

If your track system was factory installed, the crossbar anchors will be covered with a plastic cap.

Using the hex key, remove the four plastic covers to expose the crossbar sliding anchors.

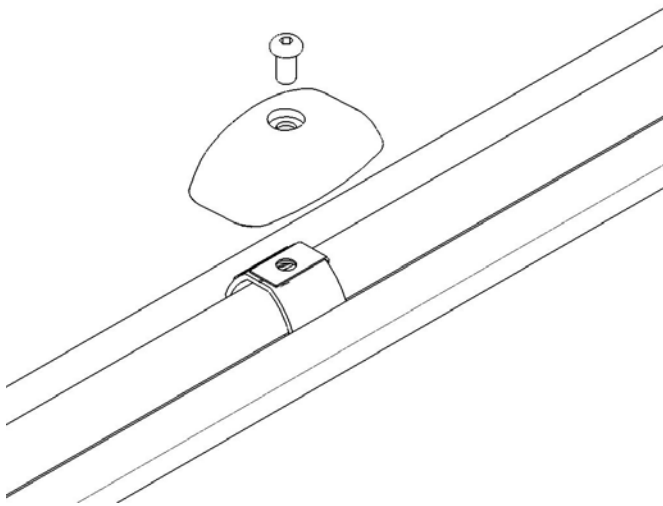

2.

Remove the crossbar end caps. Loosely attach the crossbar to the sliding anchors using the 1-1/4" screws and the hex key.

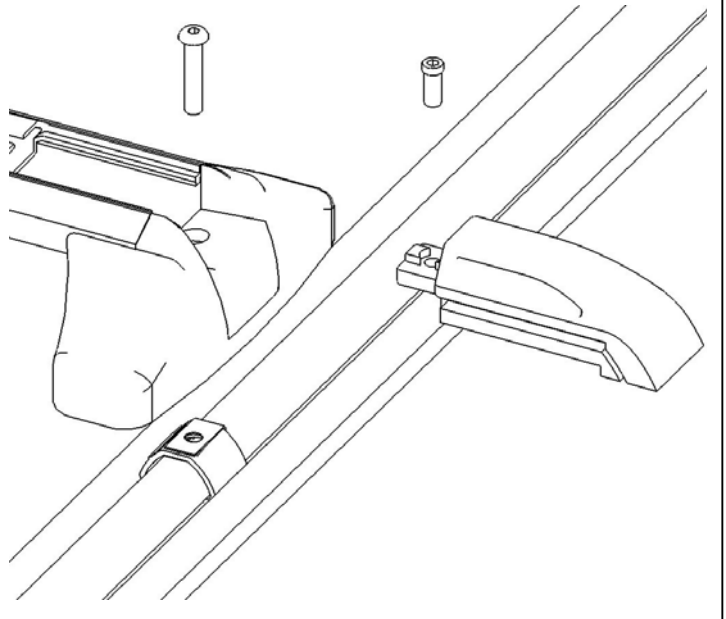

3.

Slide the crossbars to the desired locations along the length of the track.

Recommended crossbar spacing for ProRac accessories is 35" center to center.

After positioning, tighten screws with the hex key.

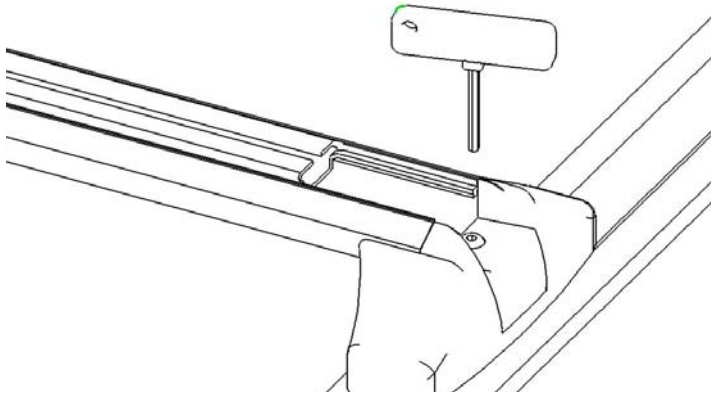

4.

Replace the crossbar end caps and secure with the 1/2" narrow shoulder screws.

Store the covers, extra screws and hex key in the vehicle glove box for future use.

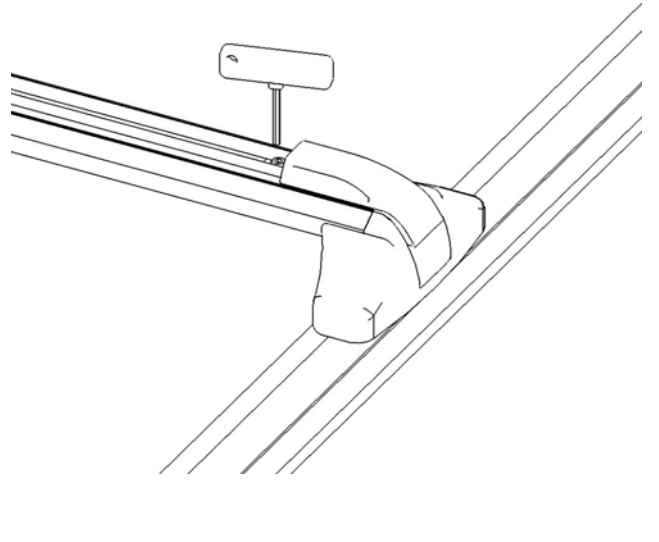

#### PRO RAC GUIDELINES

Please review the instructions and warranty carefully. Assembly and installation are the purchaser's responsibility and beyond ProRac's control. Therefore, ProRac exclusively limits its warranty to the repair or replacement of a defective ProRac product for up to three years from retail purchase. Warranty excludes damage to your vehicle, cargo, or any person or property during assembly, installation, and use.

- ◆ Do not carry more than 150 pounds (68KG) of combined cargo and accessories on ProRac crossbars. ProRac crossbars do not increase gutter or roof strength. ProRac cannot warranty loads that exceed this limit.
- ◆ Do not use ProRac crossbars and accessories for purposes other than those for which they were designed. Do not exceed their carrying capacity. Failure to follow these guidelines or the product instructions will void the warranty.
- ◆ Make sure all knobs, bolts, screws, straps, and locks are firmly attached, tightened, and locked before every trip. All fasteners must be periodically inspected for signs of wear, corrosion, and fatigue. Check your load at stops during long trips to ensure continued fastening security.
- ◆ Check all local and state laws governing projection of objects beyond the width and length of vehicle. Be aware of the width and height of your cargo since low-clearance branches, bridges, and parking garages can affect the load. Never drive with any lock, knob, or rack in an open or unlocked position. All long loads such as, but not limited to, sailboards, surfboards, kayaks, canoes, and lumber must be tied down front and rear to the bumpers or tow hooks of the vehicle.
- ◆ Remove your rack and accessories when they are not in use and before entering automatic car washes.
- ◆ All locks must be turned and moved periodically to ensure smooth operation. Use graphite or similar dry lubricant. Locks are designed to deter vandalism and theft. Remove valuable gear if your vehicle is unattended. Replacement keys are available only through your ProRac dealer.
- ◆ All cargo will affect the vehicle's driving behavior. For your safety, adapt your speed to the conditions of the road and load being carried. Obey all posted speed limits and traffic cautions.
- ◆ Due to their wind resistance, do not carry disks or wheels with covers on the ProRac bike carrier.
- ◆ Consult your ProRac dealer if you have questions regarding the operation and limits of ProRac products. Review all instructions and warranty information carefully.

© 2005 ProRac Systems, Inc.

Revised 03-21-06  
SAH400-IS

ProRac Systems Inc.  
7109 31<sup>st</sup> Avenue North  
Minneapolis, MN 55427-2848

Toll Free: 1-800-217-7133  
Phone: 763-546-5620  
Fax: 763-546-0933  
WWW.PRORAC.COM