



SLIDING TIE DOWN KIT

Package Contents:

- (4) Lifting Eye Nuts
- (4) T-Bolts
- (8) Nylon Washers

1.

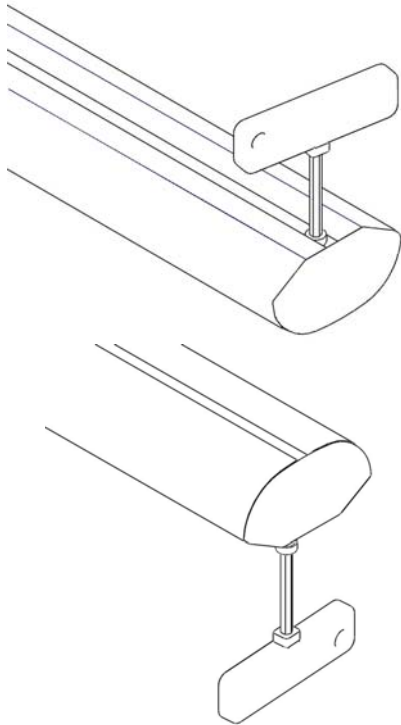

Remove plastic end caps from the load bars by unscrewing the $\frac{1}{4}$ -20 x 9/16 narrow shoulder retaining screw.

Depending on your crossbar configuration, this screw may be either on the top or bottom of the crossbar (see figure 1).

2.

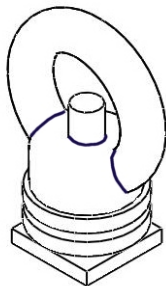

Assemble the t-bolt with two nylon washers and eye nut as shown. Repeat for the three remaining t-bolts.

3.

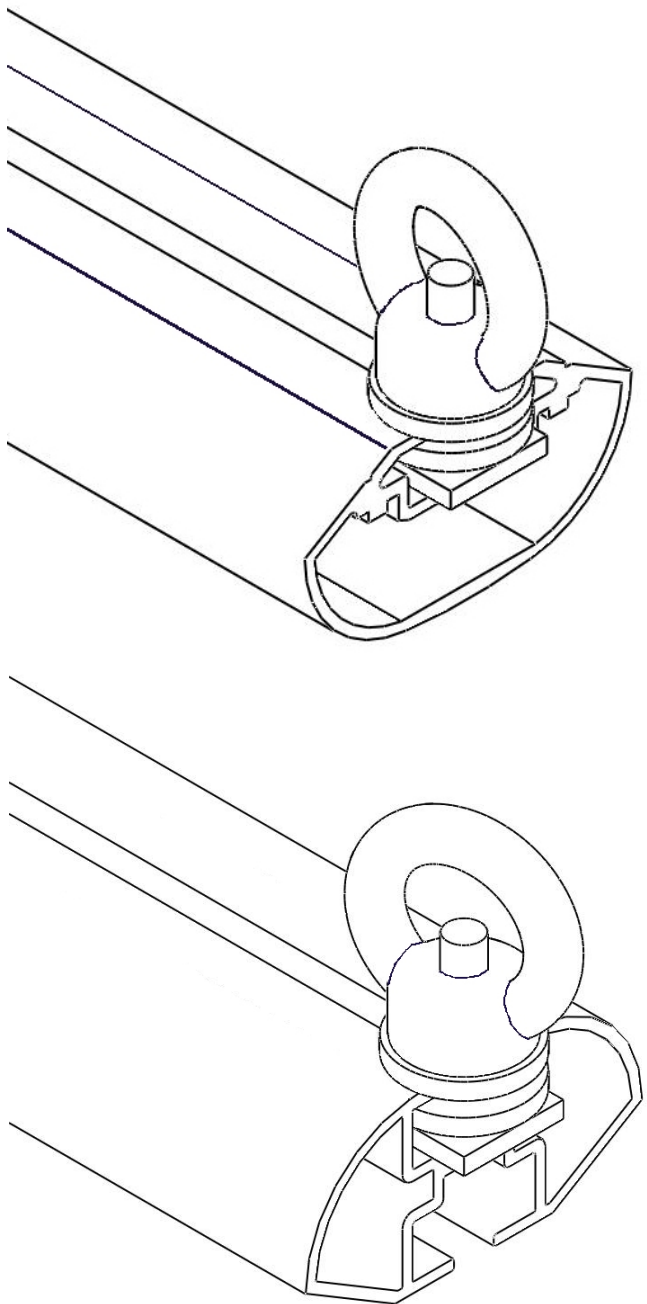

Slide the lifting eye nut assembly into the t-slot located on top of the load bar.

Make sure that one nylon washer is located in the t-slot and one is located on the outside of the bar.

Repeat for all eye nut assemblies.

4.

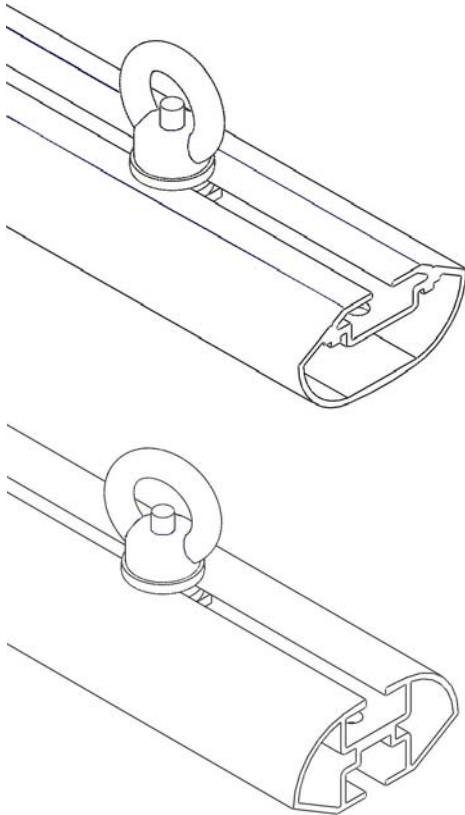

Slide the tie down assemblies to the desired location on the load bar.

Tighten the eye nut assemblies by turning the eye nut clockwise.

5.

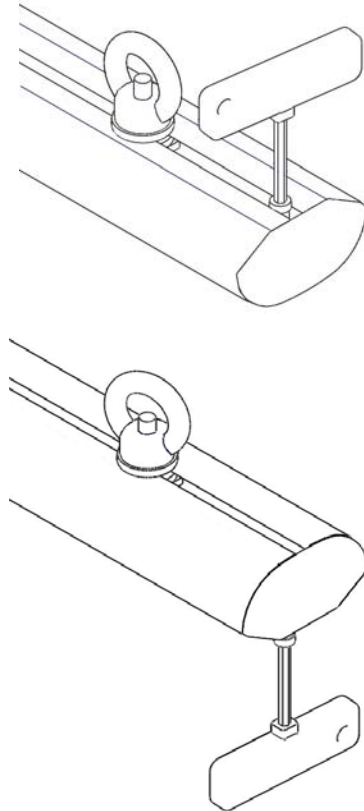

Re-install the plastic end caps on the end of the load bars by tightening the ¼-20 x 9/16 narrow shoulder screws.

DO NOT OVER-TIGHTEN THE SCREWS.

PRO RAC GUIDELINES

Please review the instructions and warranty carefully. Assembly and installation are the purchaser's responsibility and beyond ProRac's control. Therefore, ProRac exclusively limits its warranty to the repair or replacement of a defective ProRac product for up to three years from retail purchase. Warranty excludes damage to your vehicle, cargo, or any person or property during assembly, installation, and use.

- ◆ Do not carry more than 150 pounds (68KG) of combined cargo and accessories on ProRac crossbars. ProRac crossbars do not increase gutter or roof strength. ProRac cannot warranty loads that exceed this limit.
- ◆ Do not use ProRac crossbars and accessories for purposes other than those for which they were designed. Do not exceed their carrying capacity. Failure to follow these guidelines or the product instructions will void the warranty.
- ◆ Make sure all knobs, bolts, screws, straps, and locks are firmly attached, tightened, and locked before every trip. All fasteners must be periodically inspected for signs of wear, corrosion, and fatigue. Check your load at stops during long trips to ensure continued fastening security.
- ◆ Check all local and state laws governing projection of objects beyond the width and length of vehicle. Be aware of the width and height of your cargo since low-clearance branches, bridges, and parking garages can affect the load. Never drive with any lock, knob, or rack in an open or unlocked position. All long loads such as, but not limited to, sailboards, surfboards, kayaks, canoes, and lumber must be tied down front and rear to the bumpers or tow hooks of the vehicle.
- ◆ Remove your rack and accessories when they are not in use and before entering automatic car washes.
- ◆ All locks must be turned and moved periodically to ensure smooth operation. Use graphite or similar dry lubricant. Locks are designed to deter vandalism and theft. Remove valuable gear if your vehicle is unattended. Replacement keys are available only through your ProRac dealer.
- ◆ All cargo will affect the vehicle's driving behavior. For your safety, adapt your speed to the conditions of the road and load being carried. Obey all posted speed limits and traffic cautions.
- ◆ Due to their wind resistance, do not carry disks or wheels with covers on the ProRac bike carrier.
- ◆ Consult your ProRac dealer if you have questions regarding the operation and limits of ProRac products. Review all instructions and warranty information carefully.

© 2005 ProRac Systems, Inc.

FGWR010-1
Revised10-3-05